

SPE-6S-R10

6-Slot PICMG 1.3 PCIe Backplane

User Manual Ver. 1.0

1. USB1, USB2: External 4 Port USB Connectors From the Mainboard

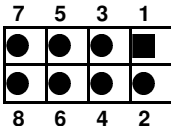

| USB1 - USB2 | | | |
|-------------|-------------|-----|-------------|
| PIN | DESCRIPTION | PIN | DESCRIPTION |
| 1 | USBVCC | 2 | GND |
| 3 | DATA- | 4 | DATA+ |
| 5 | DATA+ | 6 | DATA- |
| 7 | GND | 8 | USBVCC |

2. FAN1, FAN2, FAN3, FAN4: Fan Connector



| PIN | DESCRIPTION |
|-----|-------------|
| 1 | GND |
| 2 | +12V |
| 3 | NC |

3. ATXCTL1: Backplane to Mainboard ATX Power Control Connector



| PIN | DESCRIPTION |
|-----|-------------|
| 1 | GND |
| 2 | PSON# |
| 3 | 5VSB |

4. PWRBTN: External Power On Button



| PIN | DESCRIPTION |
|-----|-------------|
| 1 | GND |
| 2 | PWRBT# |

5. RESET: External Reset Button Connector



| PIN | DESCRIPTION |
|-----|-------------|
| 1 | GND |
| 2 | SHB_RST# |

6. PWRGD: External Power Good Connector



| PIN | DESCRIPTION |
|-----|-------------|
| 1 | GND |
| 2 | PWRGD |

7. SM-BUS: External System Management BUS Connector



| PIN | DESCRIPTION |
|-----|-------------|
| 1 | SMDATA |
| 2 | SMBCLK |

8. IOPWR: The I/O Power Connector indicators for controlling your CPU board.

| PIN NO. | DESCRIPTION | PIN NO. | DESCRIPTION |
|---------|-------------|---------|-------------|
| 1 | GND | 2 | -12V |
| 3 | +12V | 4 | GND |
| 5 | IPMB_DA | 6 | 5VSB |
| 7 | GND | 8 | GND |
| 9 | IPMB_CL | 10 | 5VSB |
| 11 | +5V | 12 | PWRGD |
| 13 | SMDAT | 14 | SHB_RST# |
| 15 | 5VSB | 16 | GND |
| 17 | SMCLK | 18 | PSOEN# |
| 19 | +3.3V | 20 | PWRBRT# |

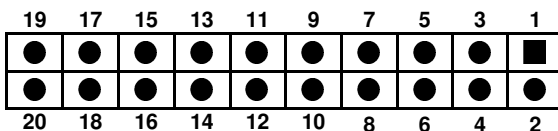

10. Notice:

- a. Recommend to use 6mm width spacer to install

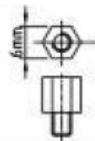

- b. Torsion must less than 6lb-inch

11. Block Diagram

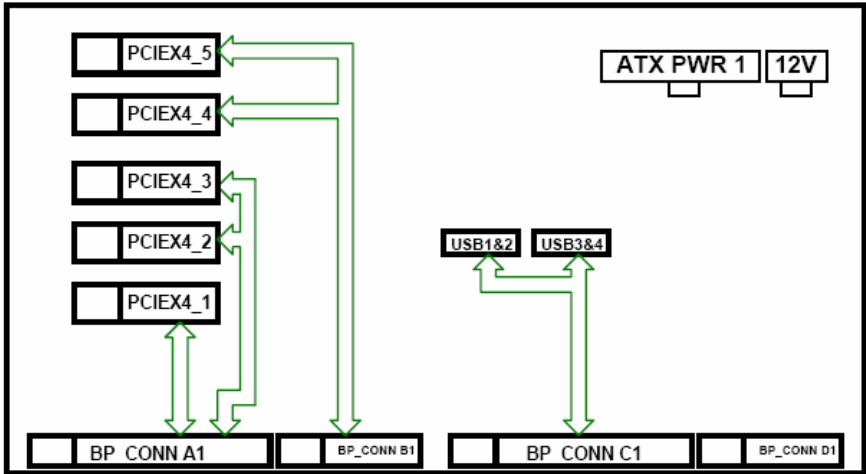

12. Dimension:

